

FCJJ-42



FCJJ-24

HORIZON ENERGY MONITOR



This ideal accessory to FCJJ-42 feeds live experiment data to your PC to be displayed as graphical data.

PRODUCT DESCRIPTION

The Ethanol Fuel Cell Science Kit shows the workings of a direct ethanol fuel cell and the principles behind the conversion of ethanol into electrical energy through oxidization. Begin the process in the ethanol/water mix container then transfer this solution into the fuel cell via silicon tubing where it will be converted into electrical energy to power a mini turbine. A demonstration of the future of fuel cell technology before your eyes.

FEATURES

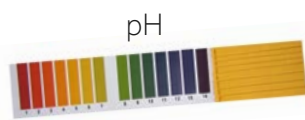

- ✓ Understanding the workings of an ethanol fuel cell
- ✓ pH paper shows change of property of the consumed ethanol fuel
- ✓ Includes experiment guide on CD, as well complete manual
- ✓ Fuel solution can be made with household items

LANGUAGE PACK

- ✓ Assembly Guide :
- ✓ Technical Support Guide:

EXPERIMENTS & ACTIVITIES

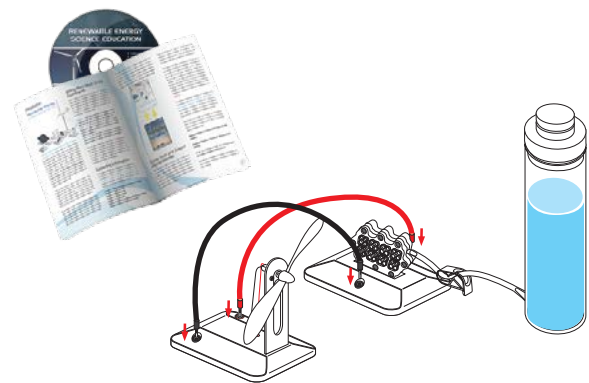

✓ Bio-energy experiments

1. Create electricity from ethanol and water
2. Exploring polarity
3. Ethanol fuel consumption
4. Exploring the effect of varying fuel concentrations
5. Create electricity from wine and beer
6. Exploring the effects of temperature



KIT CONTENT

- ✓ Fuel cell module
- ✓ Fuel solution container
- ✓ Fuel tank with lid
- ✓ Fan module
- ✓ Fan blade
- ✓ Silicon tubes
- ✓ Clamp
- ✓ Wires
- ✓ PH paper
- ✓ Syringe

CERTIFICATION

CoC, ROHS, EN71:PART1;PART2;PART3, EN62115, PHTH-EU, ASTM F963, CPSIA-LEAD, CPSIA-LEAD, CPSIA-PHTHALATES, REACH, CA.

PACKING INFORMATION

Case Pack Quantity (units):	1
Master Pack Quantity (units):	12
Packaging Type:	cardboard
20' Container (units):	3275
40' Container (units):	6680
Unit Box Length (cm/in):	30 / 11.81
Unit Box Width (cm/in):	21 / 8.27
Unit Box Height (cm/in):	9.7 / 3.82
Unit Volume (Litres/Cubic Meters):	6.1 / 0.006
Unit Box Weight (kg/lbs):	0.5 / 1.10
Case Pack Length (cm/in):	63 / 24.80
Case Pack Width (cm/in):	44 / 17.32
Case Pack Height (cm/in):	35 / 13.78
Case Pack Volume (Litres/Cubic Meters):	97.0 / 0.097
Case Pack Weight (kg/lbs):	6 / 13.23

*The cartons' size may vary between ±1-2 cm.

LOGISTICS INFORMATION

Item UPC-Code:	6942503405262
Item HS-Code:	-
Manufactured in:	Shanghai, China
Local Warehouse	Prague, Czech Republic
FOB Harbor:	Los Angeles, USA
First Ship Date:	available now
Minimum Order:	24